

FORM NO. 1.

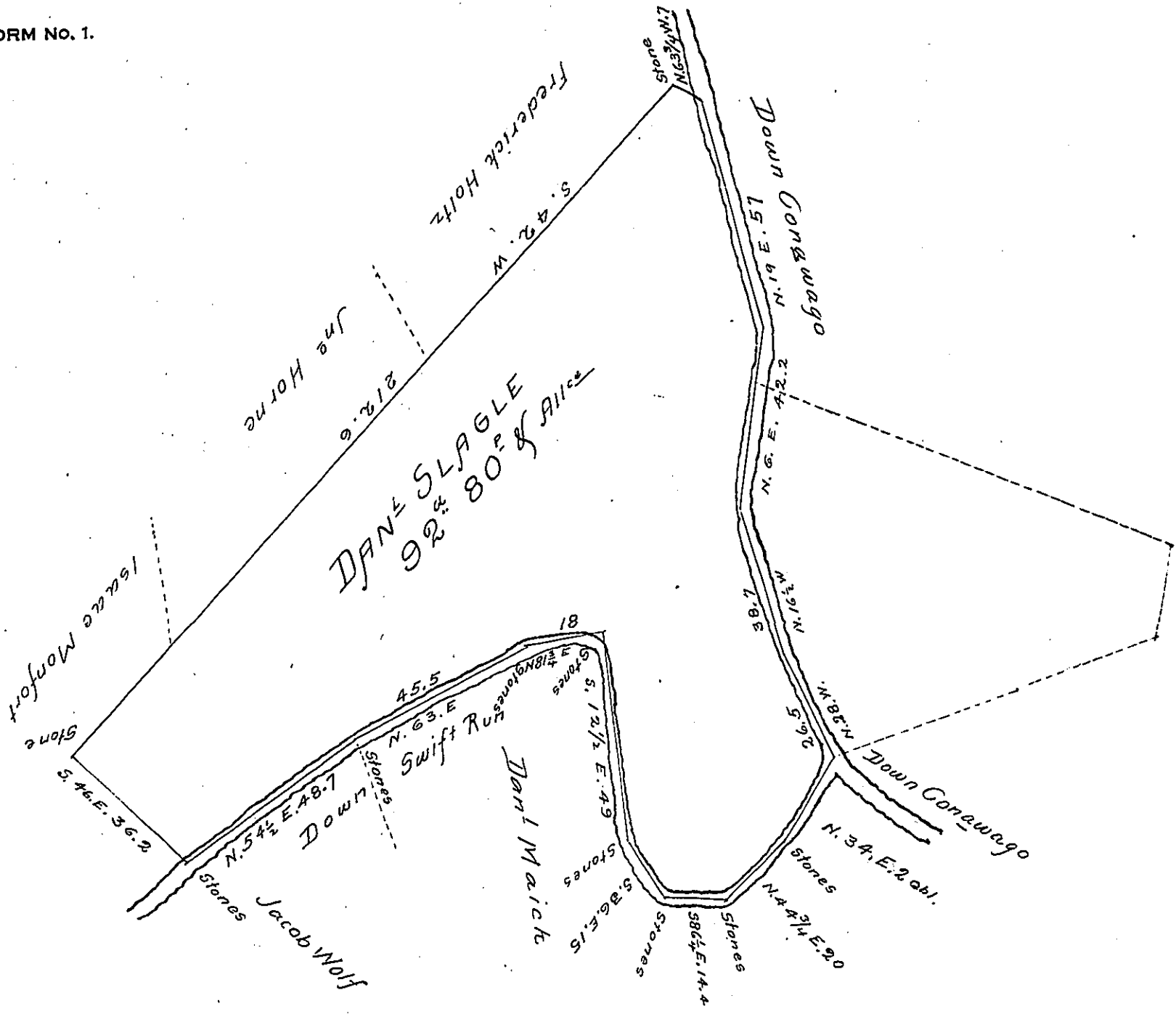

Situated in Strabane Township Adams County containing 92<sup>a</sup> 80<sup>p</sup> and the usual allowance, it being part of a larger tract said to contain 116<sup>4</sup> and Alice. Surveyed by Thomas Cookson D.S. in pursuance of a warrant granted to Danl Slagle dated the 20<sup>th</sup> of August 1747. Divided from the residue March 16<sup>th</sup> 1839

By David McMillan D.S.

To Jno Taylor Esq: S.G.

IN TESTIMONY that the above is a copy of the original remaining on file in the Department of Internal Affairs of Pennsylvania, made conformably to an Act of Assembly approved the 16th day of February 1833, I have hereunto set my hand and caused the Seal of said Department to be affixed at Harrisburg, this fourteenth day of February 1907

*Lea C. Brown*  
Secretary of Internal Affairs.